

C32-206

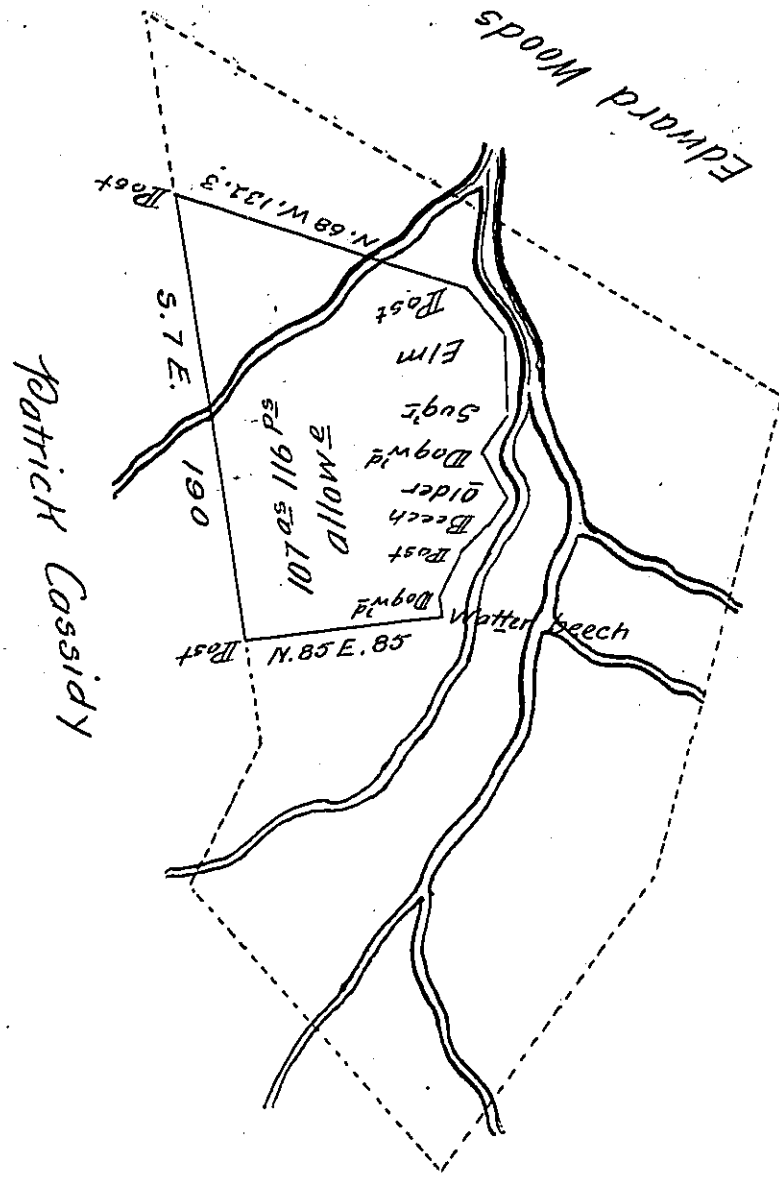

Courses & Distances down  
the Creek Beg'g. at W. Beech  
thence

|           |         |         |
|-----------|---------|---------|
| N. 8      | W. 8    | Dogwood |
| N. 30 1/2 | E. 20   | Post    |
| N. 45     | E. 16   | Beech   |
| N. 40     | E. 12   | Older   |
| N. 24     | W. 22   | Dogwood |
| N. 35     | E. 19   | Sugar   |
| N. 2      | E. 28.3 | Elm     |
| N. 35     | W. 28   | Post    |

Situate in Frankstown Township Huntingdon County Containing One hundred seven acres, one hundred sixteen perches and allowance of Six per Cent for roads &c. first surveyed in 1766 or 1767, In pursuance of an order of survey granted to Archibald McElroy dated the 1<sup>st</sup> of Aug<sup>r</sup> 1766. No 31. & resurveyed by order of the Board of Property dated the 23<sup>d</sup> Oct<sup>r</sup> 1802, it then contained 442 acres 13 ps & allow<sup>e</sup> &c. — This part resurveyed and divided from the residue of said tract the 30<sup>th</sup> April 1821. the dotted lines representing the original survey of Archibald McElroy

Peter Cassidy D.S.

Jacob Spangler Esqr.  
Surveyor Gen<sup>l</sup>

IN TESTIMONY that the above is a copy of the original remaining on file in the Department of Internal Affairs of Pennsylvania, made conformably to an Act of Assembly approved the 16th day of February, 1833, I have hereunto set my Hand and caused the Seal of said Department to be affixed at Harrisburg, this first day of June 1904.

*Joseph R. Brown*  
Secretary of Internal Affairs.